

**SPECIFICATION**

<b>Model Name</b>	AV565-WT2
<b>LCD/LED SIZE</b>	Suitable for 23" to 55"
<b>GROSS DIMENSION</b>	470 x 165 x 55 (mm)
<b>GROSS WEIGHT</b>	2.5 kg
<b>TILT ANGLE</b>	-15°/+15° degrees
<b>VESA MOUNTING HOLES</b>	400 x 400 Max
<b>DISTANCE FROM WALL</b>	68 mm
<b>LOAD CAPACITY</b>	45 Kgs
<b>COLOUR OPTION</b>	Black

\* Specifications are subject to changes without notice.

**DIMENSION OVERVIEW**

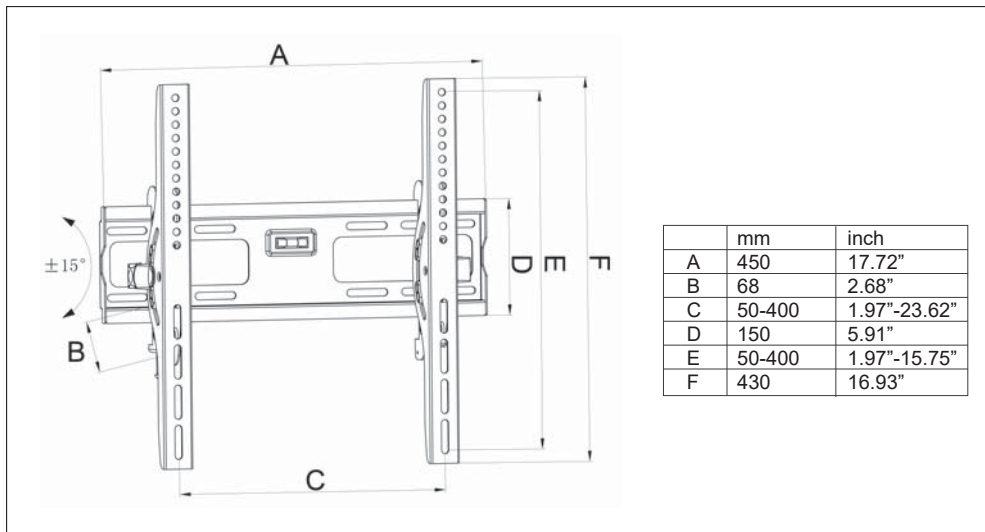

# LCD/LED Display Wall Mount



Model: AV565-WT2

19.02.2019

**WARNING**

- 1) Do not over tighten screws during installation. Over tightening can cause damage to the screws and greatly reduce their ability to support the weight of the display.
- 2) Ensure that the mounting screws are anchored to the center of studs. Use of an "edge to edge" stude finder is highly recommended.

# User Operation Guide

## PACKAGING CONTENT

	<b>Item</b>		
	A	Bolt M5x16	4 sets
	B	Bolt M5x30	4 sets
	C	Bolt M6x16	4 sets
	D	Bolt M6x30	4 sets
	E	Bolt M8x16	4 sets
	F	Bolt M8x30	4 sets
	<b>Item</b>		
	G	Lag bolt St8x50	4 sets
	<b>Item</b>		
	H	Concrete anchor 10x40	4 sets
	<b>Item</b>		
	I	Spacer with 3 holes	4 sets
	<b>Item</b>		
	J	Ø8.5x18x1.5 Spacer	4 sets
	<b>Item</b>		
	K	Ø8.5x18x1.5 Washer	4 sets

	<b>Item</b>		
L	TV Board	2 sets	
	<b>Item</b>		
M	Wall Board	1 set	

## INSTALLATION

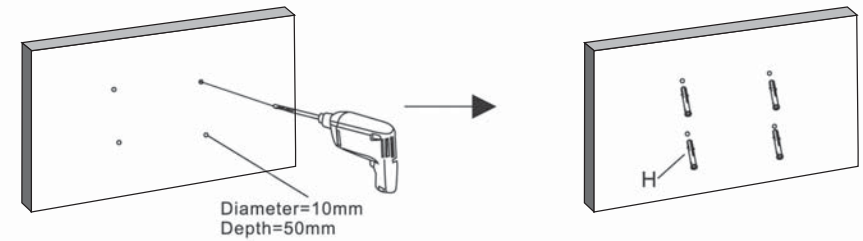

### Step 1: Mounting the wall board to the studs

Drill holes onto the wall and put 10x40 Concrete anchor (H) into the holes. Fit the wall board to the wall using ST8x50 Lag bolt (G) and Ø8.5x18x1.5 Spacer (J) as shown above / right fig.

Keep the bubble level aline.

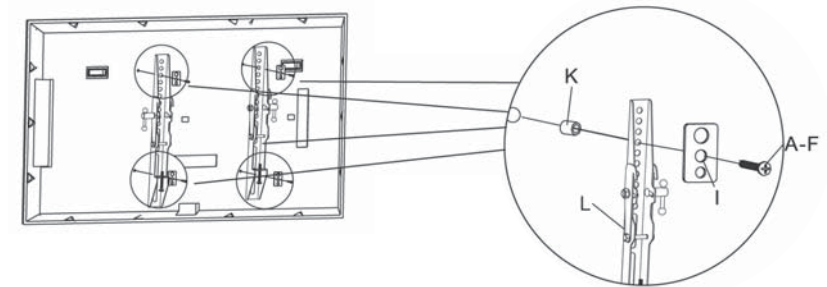
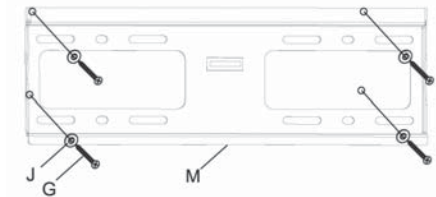

### Step 2:

Mount the TV set onto the TV board using A-F bolt packed in accessories package. Fix the screw (A-F) and Spacer (I) to the TV set mounting holes as shown in above fig.

### Step 3: Putting the wall mounted TV board with screen to the wall board

Hand the TV set mounted on the TV board (L) to the wall board (M). Finally, put the locking bar into the matched hole.

