

SPECIFICATIONS

| Technical | | |
|------------------------------|-----------------------------|------------------------------------|
| | Model: SPS-S025A1 | |
| | Signal Type | Connector type |
| Input | 1 x Stereo Audio Line-in | 1 x 3pin screw type terminal block |
| Output | 1 x Left Speaker | 1 x 2pin screw type terminal block |
| | 1 x 12V DC power | 1 x 2pin screw type terminal block |
| Output Power | 25W + 25 W | |
| Speaker Unit | | |
| | Tweeter | 1" (balanced dome) |
| | Woofer | 6 1/2" PP cone |
| Sensitivity | 89 dB | |
| Frequency Range | 20 Hz to 20 KHz (Amplifier) | |
| | 30 Hz to 18 KHz (Speaker) | |
| Treble Adjust | ± 10 dB | |
| Bass Adjust | ± 10 dB | |
| Separation | ≥ 45 dB | |
| S/N Ratio | ≥ 75 dB | |
| Power Supply | Switching Power Supply unit | AC 100~240V 50/60Hz |
| Mechanical | | |
| Housing | ABS enclosure | |
| | Product | Package |
| Dimensions (L x W xH) | 288 x 215 x 180 mm | 425 x 250 x 330 mm |
| Weight | 3.4 Kg (*Active Speaker) | 6.8 Kg |
| | 3.2 Kg (*Passive Speaker) | |
| Fixedness | 2 x Wall-Mount U bracket | |
| | 1 x Active Speaker | *With Eco Digital Audio Amplifier |
| | 1 x Passive Speaker | |
| | 2 x Wall-mount U bracket | |
| | 1 x Quick User Guide | |
| | 1 x Power Cord | |
| | 1 x Speaker Cable | |

ABTUS
S I N G A P O R E

Eco Active Speaker System

“Eco Digital Amplifier 25W per channel”



Model: **SPS-S025A1**

PRODUCT DESCRIPTION

The **ABtUS SPS-S025A1** is a new Eco Active speaker System that design to delivers quality stereo audio amplification within a speaker system. With a output power at 2 x 25 watts, this speaker provide a new generation of energy save Active speaker system that offer a powerful and versatile answer to any installation's needs especially in a multi media class room. With it's unique "Auto Power ON/Off base on with input detection" and digital amplification circuit, it consume as low as 4.5 watts of power in a typical usage, which make this the most Eco-friendly amplification solution ever.

PRODUCT HIGHLIGHTS

- Integrated with Switching Power Supply Unit for best power efficiency
- Integrated with Digital Audio Amplifier with a low power consumption
- Integrated with input signal sensing for Auto Power ON/OFF to maximum power efficiency
- A Fully Eco Friendly Speaker System

Back Panel View

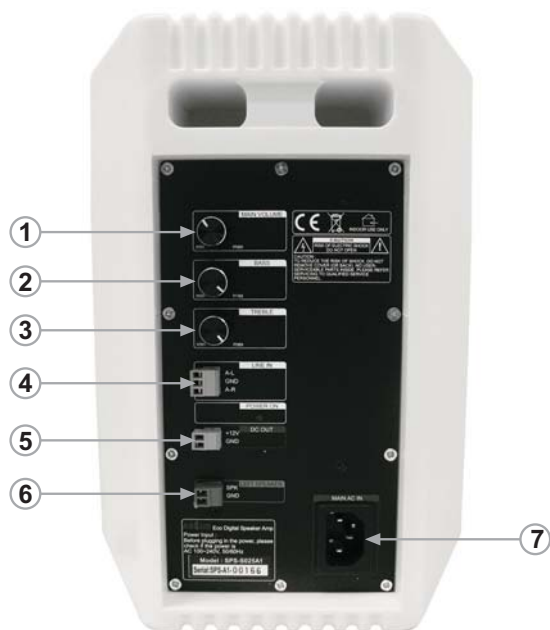

| Item | Description |
|------------------------|--|
| SPS-S025A1 | |
| 1. Main Volume | Main Volume Level Control (Analog control) |
| 2. BASS | BASS Level Control (Analog control) |
| 3. TREBLE | TREBLE Level Control (Analog control) |
| 4. LINE IN | Line Audio Input (*with 3.8mm screw type terminal block) |
| 5. DC OUT | 12V DC 1A power Output (*for supply to any external device) |
| 6. LEFT SPEAKER | Output to Left Speaker |
| 7. MAIN AC IN | Main AC power Input (*AC 100~240, 50/60Hz) |

SYSTEM DIAGRAM

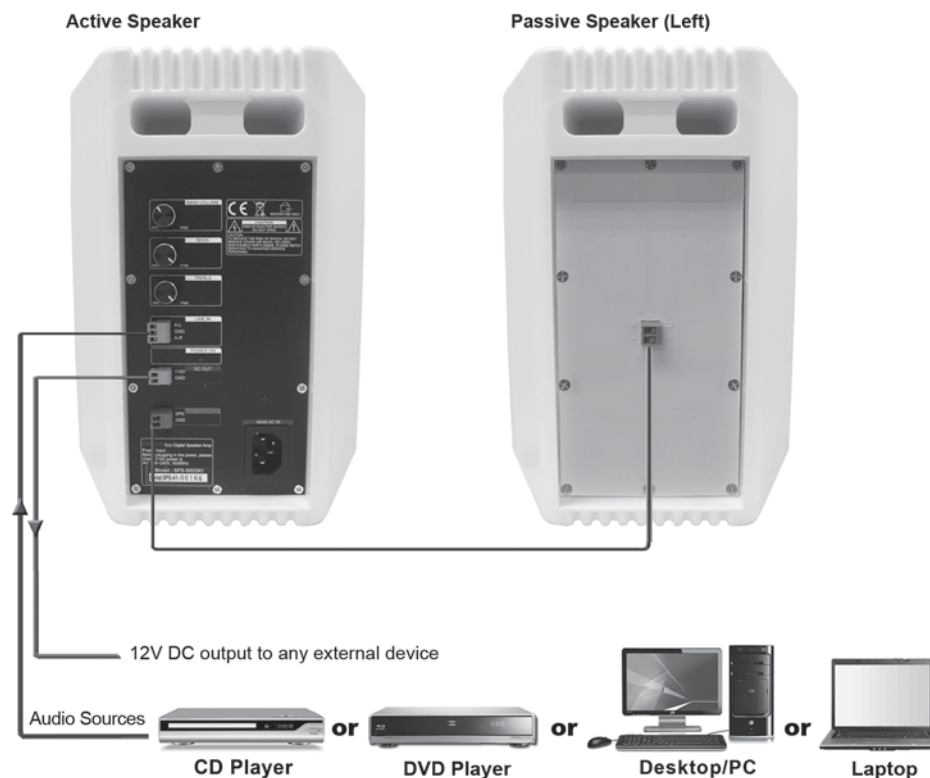

Typical Application

- Any audio integration that required simple and a eco power saving digital audio amplification speaker system
- Schools (Lab, Hall ect.)
 - Churches
 - Corporate Applications (Function Room)
 - Rental